

# PACTware

Operating Software for Configuration and Parameterization of Field Devices (FDT/DTM)

- Efficient and fieldbus-independent operation of Field Device Tool (FDT) / Device Type Manager (DTM)-based field devices from a wide variety of manufacturers
- Fieldbus diagnostics and the simulation of operating states

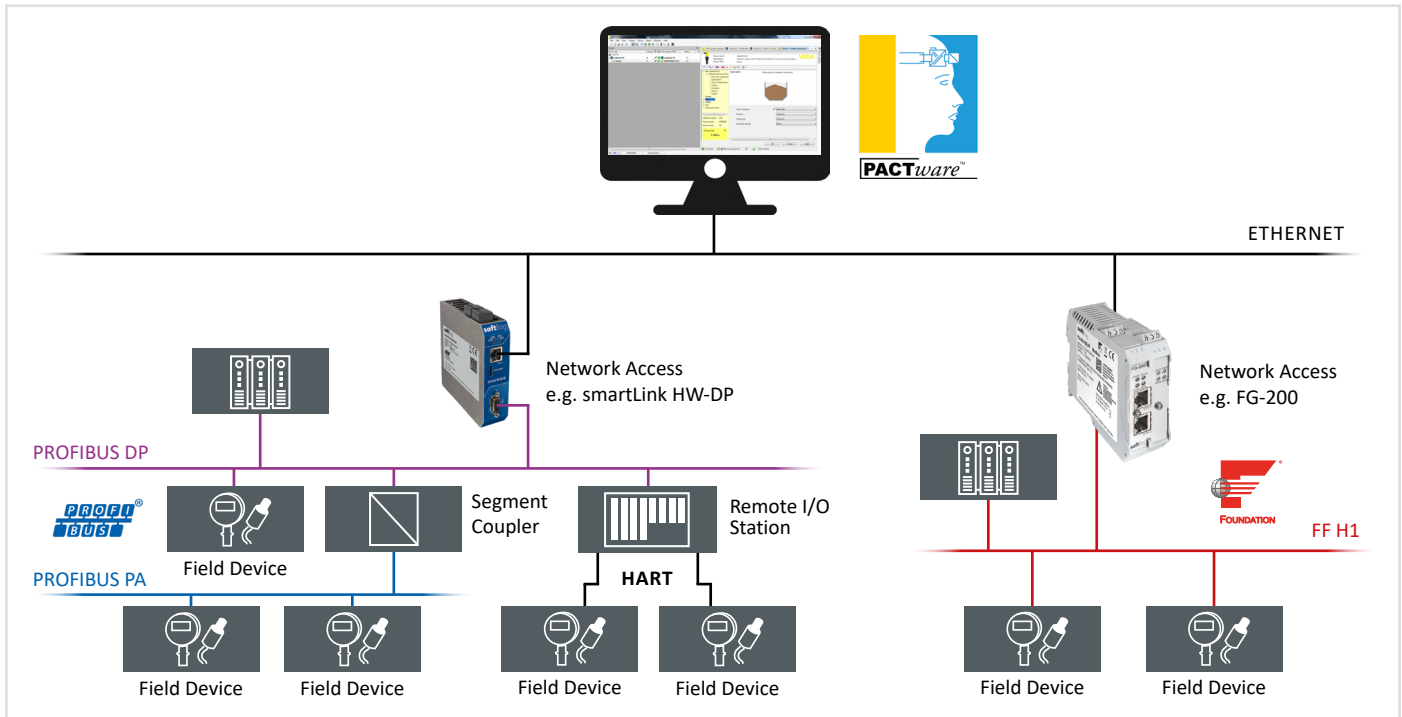

## Easy and cost-effective way to get started with plant asset management applications

- Easy central operation of field devices from different manufacturers
- Fieldbus-independent use with the corresponding ComMDTMs
- FDT/DTM standard compliant
- Software application available free of charge

## Efficient use of field devices in the process industry

- Fast plant commissioning, fast replacement of defective devices
- Simple remote device parameterization
- Comprehensive monitoring of process-critical devices
- Central management of all device parameters
- Automatic creation of plant documentation

## Technical Data

Functionality	<ul style="list-style-type: none"> <li>• Creating and opening projects</li> <li>• Connection between DTM and device</li> <li>• Data exchange between DTM and device</li> <li>• Editing of device data with the DTM</li> <li>• Device catalog</li> <li>• Project view</li> <li>• Plant view</li> <li>• Debug and error monitor</li> </ul>
---------------	--

Network Access	<p>PROFIBUS</p> <ul style="list-style-type: none"> <li>• smartLink HW-DP</li> <li>• PROFIusb</li> <li>• PBpro ETH</li> <li>• PBpro PCI</li> <li>• PBpro PCI Express</li> <li>• PBpro CompactPCI</li> <li>• PBpro PC104plus</li> <li>• PROFI104</li> <li>• mobiLink</li> </ul> <p>FOUNDATION™ Fieldbus</p> <ul style="list-style-type: none"> <li>• FG-200</li> <li>• mobiLink</li> </ul>
----------------	--

Supported Operating Systems	Windows Vista, Windows 7, Windows 8
-----------------------------	-------------------------------------

System Requirements	<ul style="list-style-type: none"> <li>• Microsoft .NET Framework 2.0</li> <li>• Adobe Reader 8.0 or higher for reading the documentation</li> <li>• 50 MB free hard disk space</li> <li>• 40 MB RAM</li> </ul>
---------------------	---

## Scope of Delivery

Software	PACTware (developed by members of the PACTware Consortium)
Documentation	User Manual

## Order Numbers

VAA-YY-023000	PACTware (free of charge)
---------------	---------------------------

## Additional Products and Services

GEA-YN-026000	<b>smartLink HW-DP</b> , Access to PROFIBUS networks via Ethernet. Supports <b>1 PROFIBUS DP segment (RS485)</b>
LRA-NN-027001	<b>smartPlus PB</b> , Licensing access to one PROFIBUS device for smartLink/smartGate
LRA-MM-027002	<b>smartPlus HT</b> , Licensing access to one HART device for smartLink/smartGate
PB-USB	<b>PROFIusb</b> , including CommDTM
DEL-NN-012311	<b>PBpro ETH</b> , single-channel (different versions), including CommDTM
PB-PRO1-PCI / PB-PRO1-PCI/LP1	<b>PBpro PCI</b> Master/Slave, single-channel, including CommDTM
PB-PRO1-PCIE / PB-PRO1-PCIE/LP1	<b>PBpro PCI Express</b> Master/Slave, single-channel (different versions), including CommDTM
PB-PRO1-CPCI	<b>PBpro PROFIBUS CompactPCI</b> interface card, including CommDTM
PB-PRO1-PC104+	<b>PBpro PC/104plus</b> card (different versions), including CommDTM
PB-PC104-MS	<b>PROFI104</b> Master/Slave (different versions), including CommDTM
GLA-EK-024102	<b>FG-200</b> , including CommDTM
DBA-KM-020410	<b>mobiLink</b> for HART applications, including accessories

Your local Softing contact:

<http://industrial.softing.com>

optimize!  
**softing**